

TECHNICAL SPECIFICATIONS

MICA HID-25 Technical Specifications

| | |
|------------------------|---|
| Light housing: | Anodized Die Cast Aluminum |
| Net Weight: | 1,057 (with battery) |
| Performance: | 1500Lm ±100Lm |
| Runtime: | MAX: 120min ±10min |
| Bulb: | HID25W/Color Temperature 6000K±500K |
| Ballast: | Digital controlled electronic circuit |
| Battery: | Rechargeable Li-ion battery pack 4800mAh |
| Reflector Diameter: | 60mm |
| Charge Time: | Approx. 4.5 h |
| Operating Temperature: | -20°C~ +50°C (not lower than -5°C at first start) |
| Charging Temperature: | 0°C ~ +40°C |
| Environment test: | IP56 |

01201_2

MICA HID-25 searchlight

CAUTIONS

- Do not throw the battery into fire, as an explosion may result!
- Maximum storage time without recharge is 6 months.
- Do not point directly into eyes or eye injury can occur.
- Do not steer IR and UV light!
- Do not use MICA HID-25 in a dangerous environment such as near inflammables or gas.
- While replacing batteries, bulbs and other accessories etc., make sure the power switch is "OFF".
- Do not immediately change the bulb after using the light to allow stored energy time to dissipate to avoid electric shock.

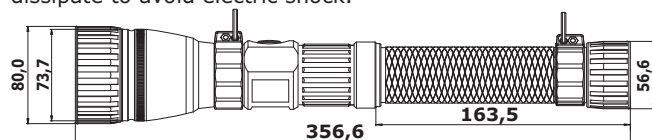

Charger connector

MICA HID-25 SET INCLUDES:

| | |
|-------------------------|-----------|
| MICA HID-25 lamp | (11480) |
| 4800 mAh Li-Ion battery | (11490_2) |
| 230 VAC charger | (11482) |
| Table charging dock | (11483) |
| Travel case | (11484) |
| Shoulder strap | (11485) |

WARRANTY

Your MICA lamp, battery and charger are guaranteed for one year from date of purchase against all defects in materials and workmanship. During the warranty period, these units may be serviced by an authorized MICA service agent only. For after-sales service, contact your local MICA dealer.

ACCESSORIES/SPAREPARTS Product No

| | | | |
|---------------------------------|---------|-------------------------------|---------|
| 12-24 VDC automatic car charger | 11236 | | |
| 2400 mAh Li-Ion battery | 11490_1 | HID 15W lamp module | 11455_1 |
| 4800 mAh Li-Ion battery | 11490_2 | HID 25W lamp module | 11455_2 |
| Flood lens | 11430 | HID 15W ballast module | 11456_1 |
| Red filter 620 nm | 11431 | HID 25W ballast module | 11456_2 |
| Green filter 560nm | 11432 | HID aluminum lens cap | 11457_1 |
| Blue filter 430-460 nm | 11433 | HID rubber front cap cover | 11458_1 |
| Amber filter | 11434 | HID rubber rear cap cover | 11458_2 |
| Infra-Red filter 850 nm | 11435 | HID clear hardened glass lens | 11459_1 |
| Infra-Red filter 950 nm | 11436 | | |
| Ultraviolet filter 365 nm | 11437 | | |

MICA ELEKTRO OY LTD. LAMP SERVICE

P.O. Box 42, FIN-00381 Helsinki, Finland
Visit address: Höyläämötie 11 B, FIN-00380
Email: info@mica.eu Internet: www.mica.eu

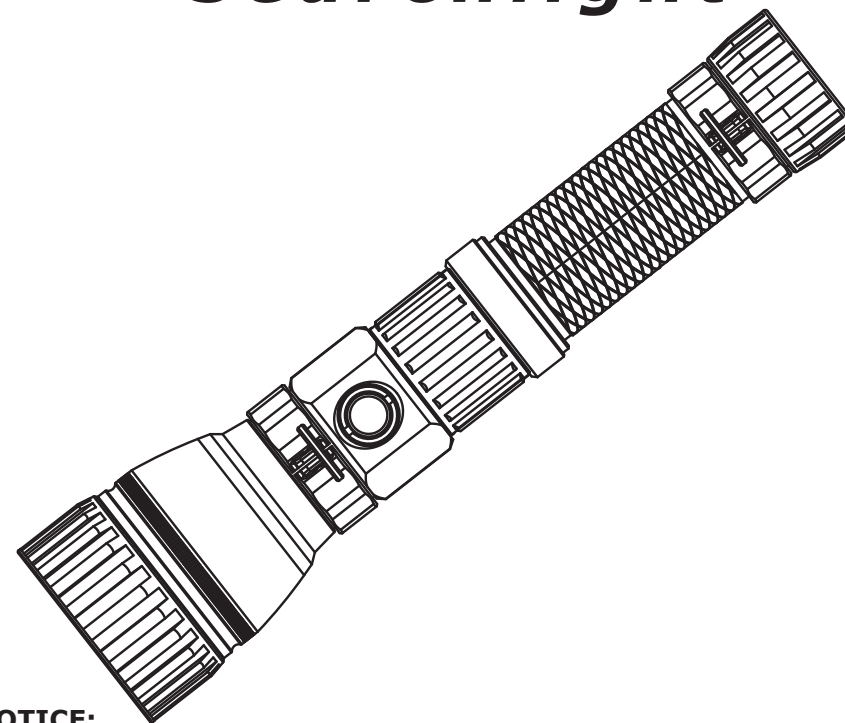

NOTICE:

Before using this light carefully read all safety information

Store the manual for a later use.

MICA HID-25 utilizes High Intensity Discharge (HID) Metal Halide lamps that are controlled by electronic ballasts, capable of producing 15KV. HID lamps produce substantially more lumens per watt than filament light sources as used in most flashlights. There are inherent risks associated with the use of HID lights and Lithium ion batteries. Strict adherence to the operating instructions is imperative. MICA HID-25 has been designed to minimize these risks and many years of safe operation can be expected.

Mica Elektro Oy Ltd. P.O. Box 42, FIN-00381 Helsinki
tel +358-9-5617666 fax +358-9-56176688
email info@mica.eu internet www.mica.eu

— mica —
elektro

BEFORE USE

Charge the lamp before use. The battery is discharged when the lamp is stored and it must be recharged prior to use.

CHARGING

Batteries can be charged and discharged for hundreds of times. When a noticeable drop in battery performance occurs it is time to replace the battery module. We recommend you change the battery once a year depending on usage. Shorter durations may be necessary with extensive use of the light.

While charger is not in use disconnect the power supply. **Do not leave the battery on the charger past full charge indication.** Overcharge can shorten the lifespan of the battery. **Before charging, make sure that the power switch is OFF. Do not short circuit the battery.**

1. Before charging, turn off the light and keep the power off during charging.
2. Open the rubber waterproof cover located at the bottom of the light (on end cap), connect the male jack of charger to the female receptacle of the HID. **(Caution, use only the supplied HID chargers, do not use other chargers as this will cause battery failure and cause the battery to overheat and possibly explode).**
3. Connect the charger plug to AC wall power or the DC power source (if DC charger is used).
4. Charging time is 4,5 hours for MICA HID 4800 mAh battery.
5. When the charge is complete and the Green LED is on unplug the charger from the power source and disconnect the battery jack from the MICA HID-25. Replace the rubber cap of the female receptor (on end cap) to prevent water from seeping in.
6. The optional Battery Charger Stand may be used to charge a spare Lithium-Ion battery with either the AC or DC battery chargers.

While charging HID-25 can be used, however, the electric current will be much higher. Therefore, it is suggested not to turn on the light while charging. **When charging for long periods of time, the charger and battery will get hot. This is normal.** If excessive heat or odor is noticed disconnect the charger immediately.

The charger uses a 2-color LED indicator:
When connecting power the LED will illuminate **Green**.
While charging the LED will illuminate **Red**.
When fully charged the LED will again illuminate **Green**.

NOTE! Do not leave the lamp or battery on charger past full charge or the OVERCHARGE SAFETY FUNCTION protection will activate.

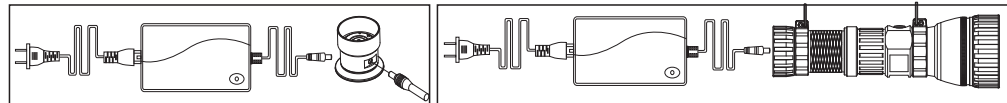

OVERCHARGE SAFETY FUNCTION

When turning on your lamp after recharge and if it does not ignite properly, reconnect the male jack of AC charger to the female receptacle of the HID-25 and plug the charger into AC power source and rapidly press the on/off switch until the light ignites. Turn off the light and disconnect the charger. These procedures need to be followed if the light is in an overcharge condition. A safety circuit is built into the battery to protect the Lithium Ion battery.

USING MICA HID-25

When starting the lamp for the first time (cold start), it is recommended to leave it on, for one minute before turning it off. This allows the lamp time to achieve sufficient temperature. When warming up it is normal for the lamp to flicker. The light emitted from HID is a higher Kelvin temperature (bluer in color), than ordinary flashlights. Full light output occurs in 10-15 seconds. If momentary turning off is needed you can instantly restart the light without worrying about damage or cooling down. It is recommended not to flash the light, as this will shorten the runtime and lamp life.

MAINTENANCE

Do not attempt to dismantle the electronic ballast or lithium pack. Contact your dealer for repairs and replacements. **Only use the original MICA charger and battery. Your dealer has spare batteries and chargers available.** Users may replace all spare part entities that can be purchased as spare parts.

LAMP AND BALLAST REPLACEMENT

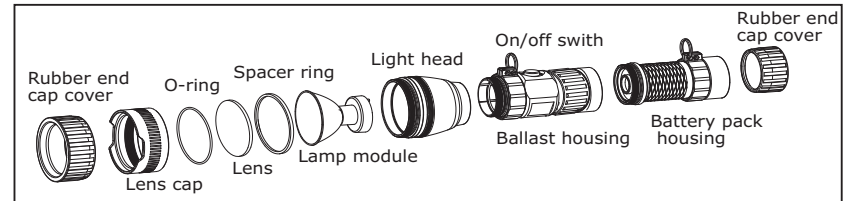

Before replacing lamp, make sure the light is OFF for a minimum of 10 minutes or longer to ensure any stored power has dissipated, to avoid electric shock from stored energy in the ballast, and temperature of lens has cooled enough to avoid being burned from high temperature.

Rotate the lens cap counter clockwise to access the lamp. While installing the lamp module, inspect the rubber o-rings for chaffing or breakage, replace if signs of wear. There is a plastic spacer between the lens and the outer reflector. The flat side faces the lens and the slotted side faces the reflector. Check the rubber seal under the clear lens for wear or breakage, replace if signs of wear. A dab of silicon lubricant or low mineral petroleum gel should be used on the threads of the light head before replacing the lens cap. Be careful not to cross thread and DO NOT FORCE or you will void your warranty and your light will be rendered inoperative.

BATTERY REPLACEMENT

Notice: While replacing the battery, please make sure that your HID is in the OFF position, otherwise damage can result to the lamp.

CAUTION: Maximum storage time without recharge is 6 months.

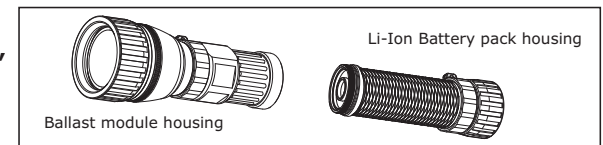

CHANGING COLOUR FILTERS

To install colored filters

- Step. 1 Remove the rubber lens protector from light head
- Step. 2 Install colored filters, making sure it is well seated.
- Step. 3 Replace rubber lens protector and press all the way on.

To remove colored filters

- Step 1. Remove rubber lens protector
- Step 2. Grab the end of the lens in the through the finger slots on the light head and remove
- Step 3. Replace rubber lens protector.

Warning: Do not steer IR light and UV light!

